

Technology Gentle to the Ecology
Teikoku Diaphragm Pump

TEIKOKU

METERING PUMPS

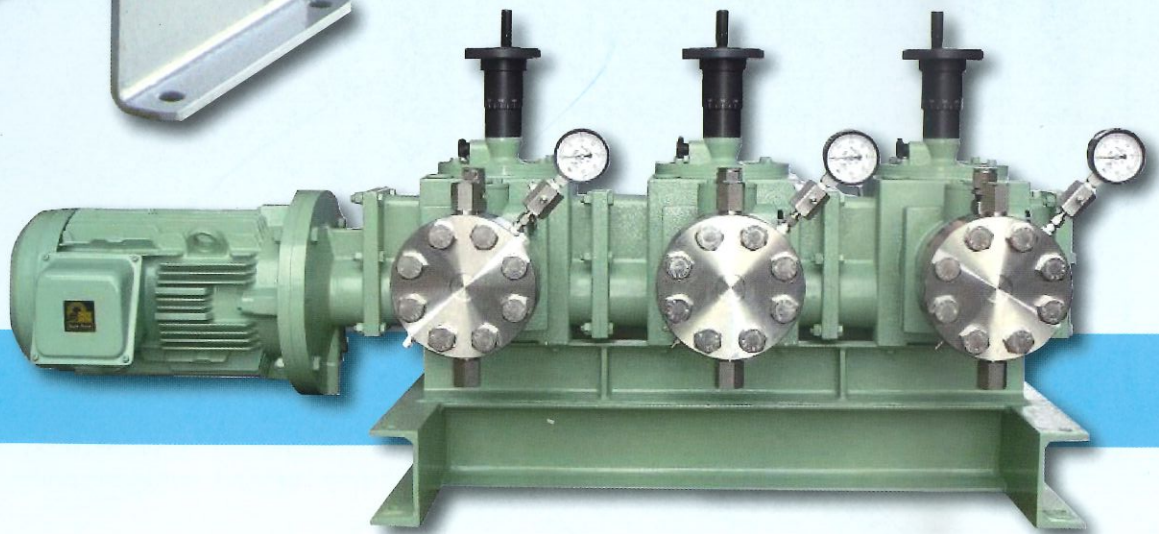
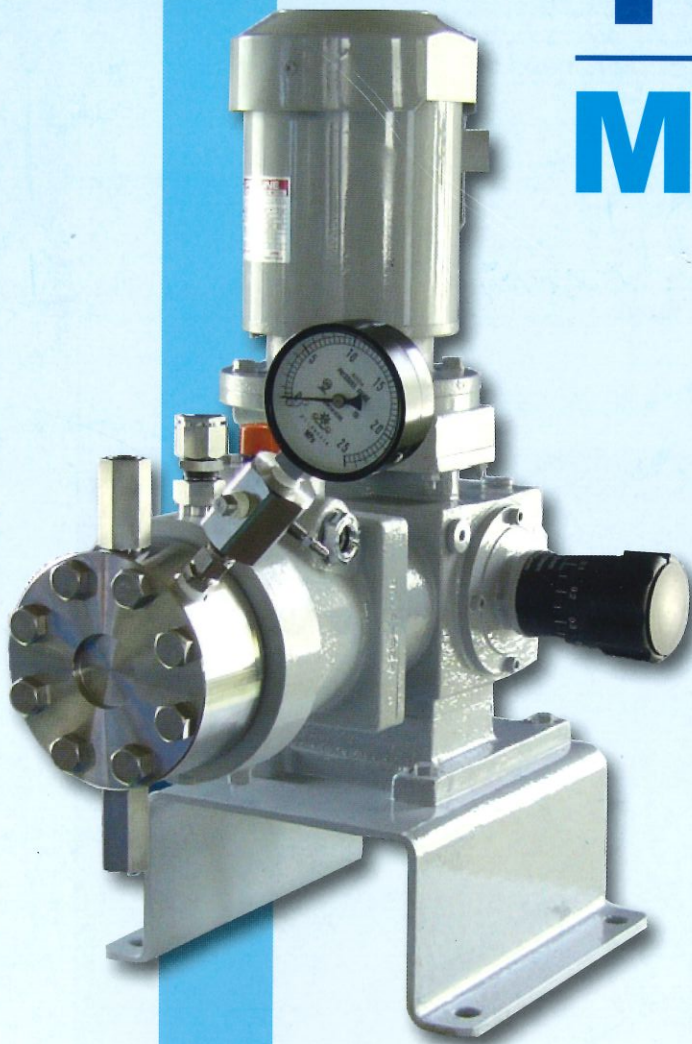

TEIKOKU ELECTRIC MFG. CO., LTD.

Teikoku has accumulated various kinds of expertise as a pump manufacturer with main focus on sealless pump technology and one significant item is the reciprocating pump on the listings. Thousands of units have already been delivered to the market with the reputation of one of the finest ultra-high precision metering pumps in the world. Now, after the dissolution of licencee contract with the original developer from Germany, Teikoku Metering pump has emerged with her unique design like a phoenix. Ultimate satisfaction and a peace of mind guaranteed !

《Specifications》

Discharge capacity	0.005~3,900 L/h per pumphead
Discharge pressure	Max. 50 MPaG
Temperature	Max. 200 °C
Viscosity	Max. 25,000 mPa · s
Solid size	Max. 1.0 mm
Standard to apply	API 675

Please contact us if the required duty is out of above range.

《Advantage》

- Best class suitability for handling toxic, flammable & dangerous fluids, strong odor fluids, solidifying fluids, deteriorating fluids in exposure to atmosphere (It is compliant to The High Pressure Gas safety Law, KHK Japan).
- Solid suspension fluid and high viscosity fluid can be handled.
- Its state-of-art stroke length adjustment enables high precision metering in very wide range of flow-rate.
 - Reciprocating accuracy ±1% or less
 - Repeatability accuracy ±3% or less
 - Linearity ±3% or less
- The most durable check valves shall be outfitted to be the best suited for given conditions.
- Diaphragm rupture detector is a standard outfit of PTFE diaphragm pump.
- Reengineered stroke length adjustment, combination & replenishing valve, etc., has accomplished the diminished number of constituent parts and the enhanced maintainability.
- Its unique sealing design and the production know-hows has accomplished very reliable safety feature and reliability.

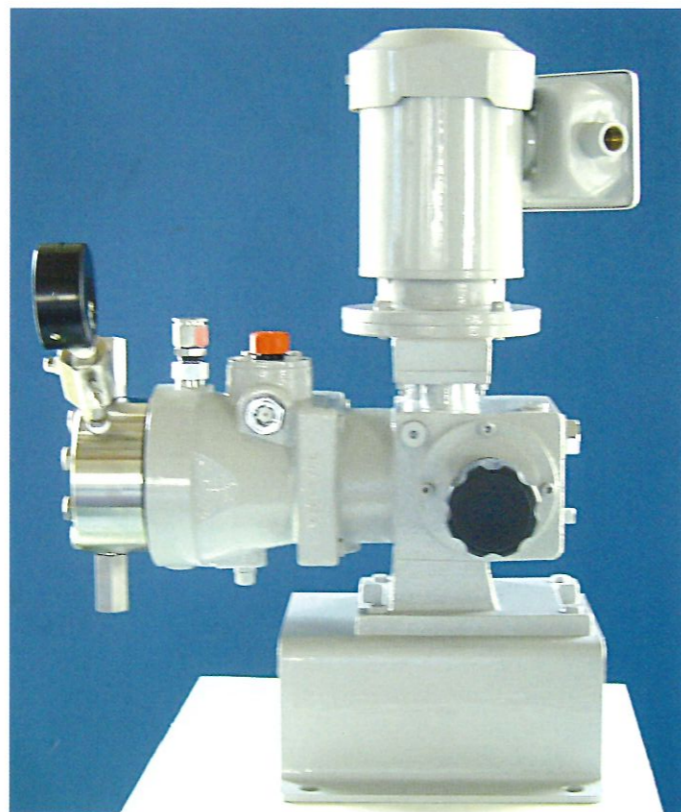

《Material construction》

	Standard	Semi-standard
Pump body	SUS304	SUS316
valve body	SUS304/SUS316	SUS316
Diaphragm	PTFE/SUS316	PTFE/SUS316
Check valve	SUS316	SUS316
Non-wetted part	SS, FC & others	SS, FC & others

※ Please contact us for other material options.

《Production Range》

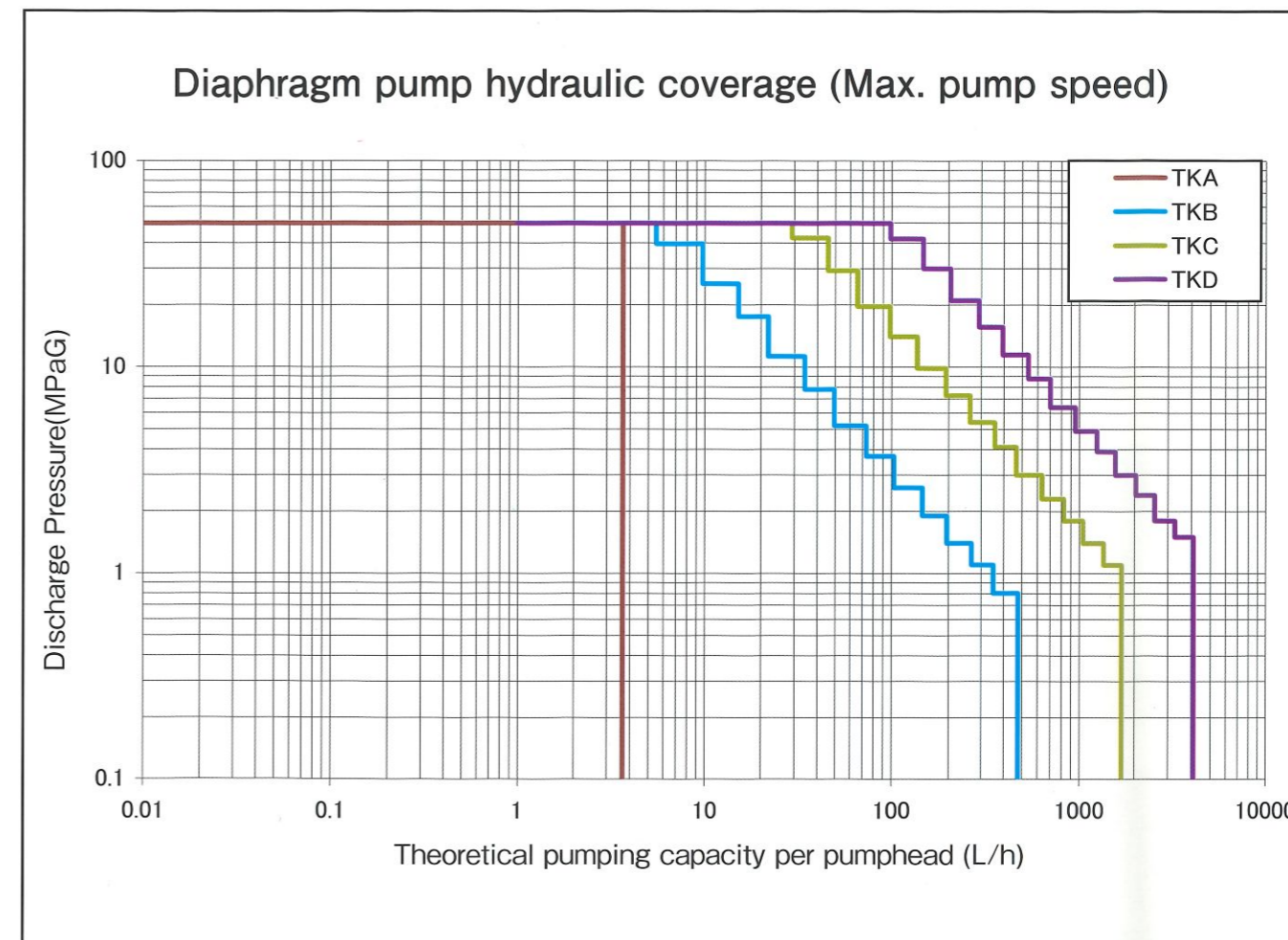

※ Multiple pumpheads up to six(6) can be built and a manifold to tie those heads is available upon request.



Diaphragm Rupture detector



Combination valve
Air filter
Sight glass

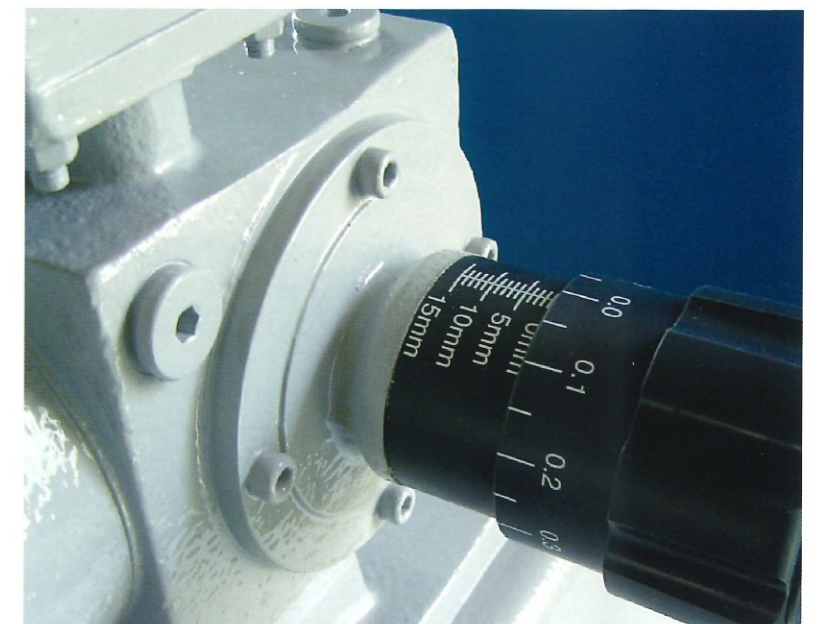

Stroke length adjustment dial knob

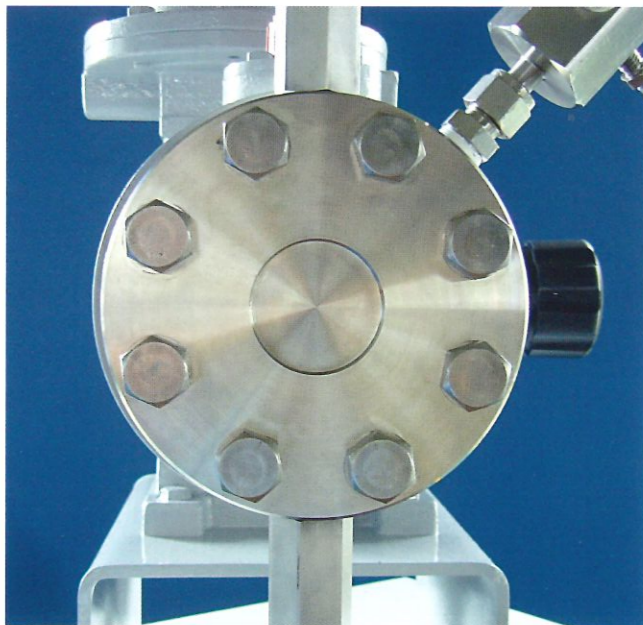

Pump body

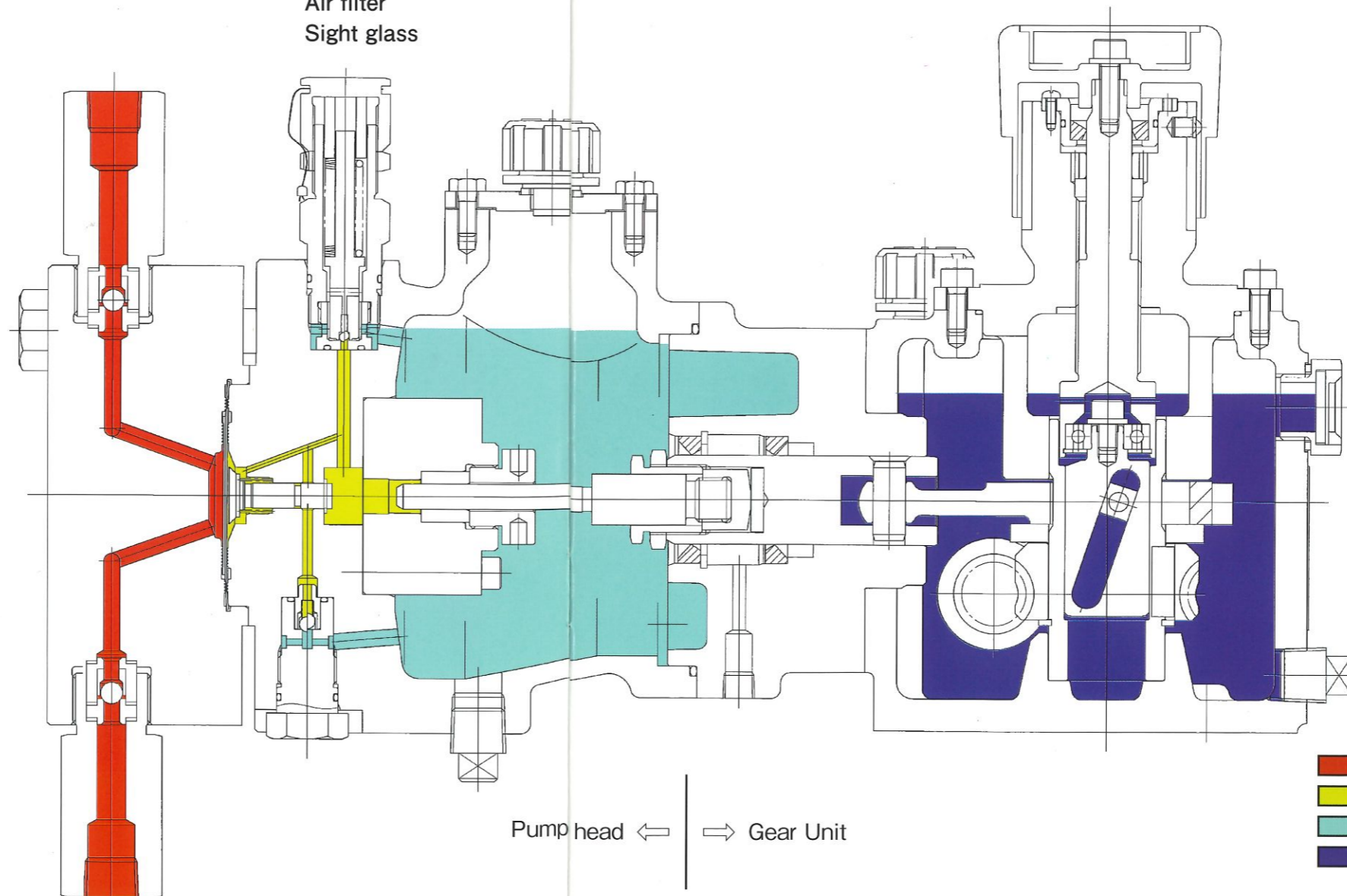

Pump head ← | → Gear Unit

- Liquid pumped
- Hydraulic oil in hydraulic chamber
- Hydraulic oil in the reservoir
- Gear lub oil

PTFE Diaphragm Pumphead

- Maximum discharge pressure upto 35MPaG can be achieved
- Continuous long operation can be guaranteed by specially treated PTFE diaphragm.
- Diaphragm Rupture detector (Local monitoring) is outfitted as standard feature.

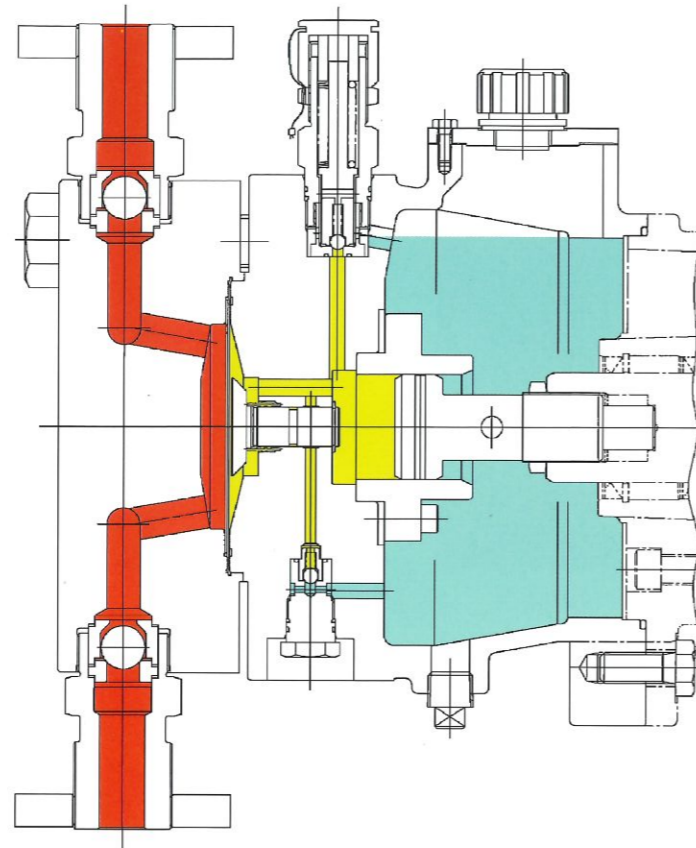

Metal Diaphragm pumphead

- Maximum discharge pressure upto 50MPaG can be achieved
- Maximum 200°C liquid can be pumped.
- Metal diaphragm disallows permeation of liquid into hydraulic chamber.

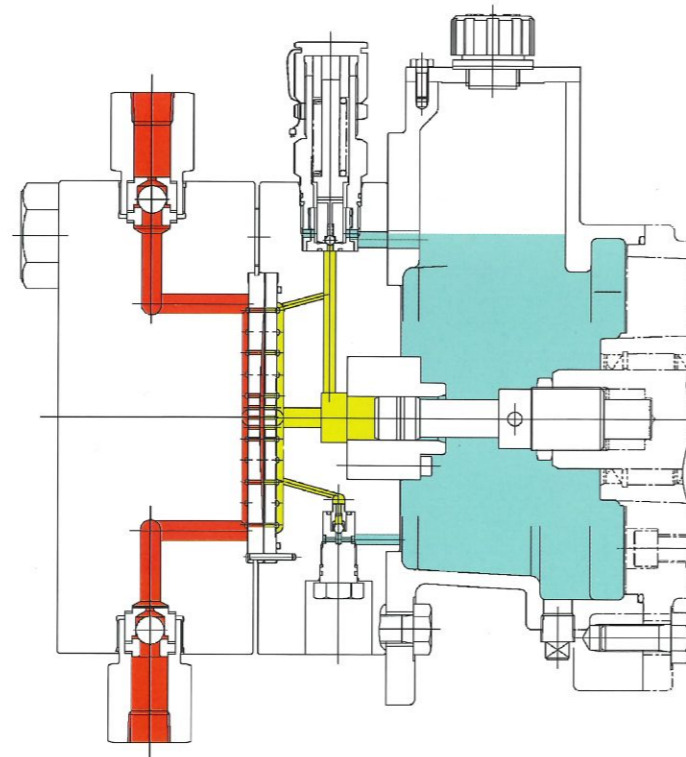

《Check valve》

- **Ball valve**
Most commonly used type of valve.
High precision dosing is achieved by limiting the excessive motion of valve balls.
When the pumped fluid contains any slurry, this type is preferably chosen.
- **Disc valve**
Spring loaded plate disc is better suitable to handle high viscous fluid and to larger size valves for higher flow.
- **Customized Special design**
Uniquely designed valve is available for special application upon request.

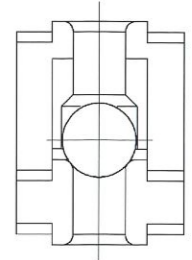

Ball valve

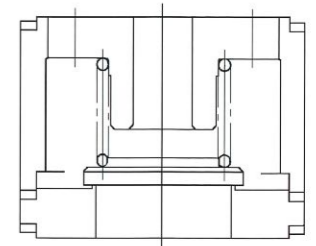

Disc valve

《Accessories》

Following accessories and peripherals are available for Teikoku metering pump.

Safety valve / Relief valve

Install in pump discharge line for protection of the piping.

Pressure retaining valve

Install in the discharge line when differential pressure between suction and discharge is less than 0.7MPa.

Pulsation Damper (Bladder Type, Diaphragm type, & Metal bellows accumulator)

Install in pump suction line when pressure-loss by hydraulic pulsation needs to be reduced.
Install it in discharge line when pulsation is required to be suppressed.

Diaphragm Rupture Detector pressure switch/transmitter

When diaphragm rupture to be monitored remotely, Pressure switch/Transmitter is hooked up to the rupture detector.

Calibration pot

Install calibration pot when discharge flow need to be checked easily.

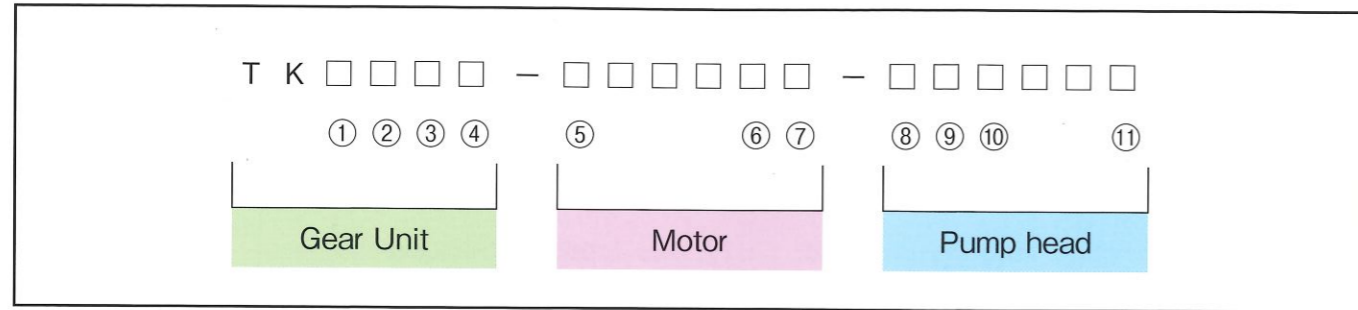

Gear Unit	Pump head
<p>① Gear unit type A : Stroke length 0~10mm variable B : Stroke length 0~15mm variable C : Stroke length 0~20mm variable D : Stroke length 0~30mm variable</p> <p>② Numbers of Gear-units Single-head design : Always 1 Multi-heads design : 1, 2, 3, ...</p> <p>③ Gear ratio J : 54 K : 17 L : 12.5 M : 10 N : 8.33</p> <p>④ Stroke length adjustment M : Manual</p>	<p>⑧ Pump head D : Metal single diaphragm S : PTFE sandwich diaphragm</p> <p>⑨ Material construction M : SUS304 N : SUS316 Z : Special</p> <p>⑩ Plunger diameter plunger diameter (mm) to be indicated.</p> <p>⑪ Special specifications Blank : Nothing F : Full jacketed S : Semi jacketed</p>
Motor	
<p>⑤ Motor Rated output (kW) Rated output to be indicated (0.2, 0.4, ...)</p> <p>⑥ Motor type S : Standard V : VFD motor Z : Others</p> <p>⑦ Motor Pole Numbers No. of pole to be indicated (2, 4, ...)</p>	

A

Acetaldehyde
 Acetic acid
 Acetone
 Acetonitrile
 Acrylonitrile
 Adipic acid
 Alcohol
 Alkoxysilane
 Aluminium hydroxide
 Aluminium sulfate
 Amino acid
 Aniline
 Aqueous ammonia

B

Benzene
 Butadiene
 Butanediol
 Butane
 Butylcatechol
 Buthyne

C

Caprolactam
 Carbon tetrachloride
 Caustic soda
 Chlorodisilane
 Chlorobenzene
 Chloromethane
 Citric acid
 Cyclohexane
 Cyclopentane

D

Decane
 Dibutyl peroxide
 Dichlorosilane
 Diethyl sulfate
 Diethylene glycol
 Dimethylamine
 Dimethylether
 Dimethylformamide
 Dioctyl Phthalate
 Dimethyl Sulfate
 Dimethyl Disulfide

E

Edible oil
 Epichlorohydrin
 Ethanol
 Ethyl acetate
 Ethyl acrylate
 Ethylene chloride
 Ethylenediamine
 Ethylen
 Ethyl chloride
 Ethylene glycol
 Ethylene oxide
 Ethylbenzene

F

Fatty acid
 Ferrous sulfate
 fish oil
 Formalin
 Freon
 Fuming sulfuric acid

G

Gamma-Butyrolactone
 Glycerin

H

Heavy oil
 Heptane
 Hexafluoropropylene
 Hexamethylene Diamine
 Hexane
 Hot Water
 Hydrazine
 Hydrazine hydroxide
 Hydrofluoric acid
 Hydrogen chloride
 Hydrogen Peroxide
 Hydrogen sulfide

I

Insulation oil
 Iodide
 Isobutane
 Isobutylene
 Isophthalonitrile
 Isoprane
 Isopropyl alcohol

K

Kerosene

L

Latex
 Lauryl lactam
 Liquid ammonia
 Liquified CO2
 Liq. Sulfur Dioxide

M

m-Xylylenediamine
 Methacrylic acid
 Methanol
 Maleic anhydride
 Methyl cyclohexane
 Methyl chloride
 Methylene chloride
 Monomethylamine
 Methyl ethyl ketone
 Methyl mercaptan

N

Naptha
 Naphthalene
 n-butane
 Nitric acid
 n-heptane
 n-hexane
 n-pentane
 Nujol

O

o-Cresol
 Octane
 o-Nitrotoluene
 Organosilicon Compound

P

Palm oil
 Paraffin
 Paraxylene
 Pentane
 Phenol
 Phosphorous Oxychloride
 Phthalic acid
 Phthalonitrile
 Poly Aluminium Chloride
 Polyether
 Propane
 Propylene
 Propylene oxide
 Pyridine

Q

Quinoline

S

SAKE Soap
 Saline Water
 Sea Water
 Silane
 Silicone oil
 Silicon tetrachloride
 Stearic acid
 Sulfur
 Sulfuric acid

T

Tetrachloroethylene
 Titanium(IV) chloride
 Toluene
 Transformer Insulation Oil
 Trichloroethane
 Trichloroethylene
 Trichlorosilane
 Triethylaluminium
 Trifluorochloroethylene
 Trifluoromethanesulfonic Acid
 Triisobutylaluminium
 Trisodium phosphate
 Turpentine

U

UDI Water
 Urea

W

Vegetable juice
 Vinyl acetate
 Vinyl chloride
 Vinylidene Fluoride
 Vinyltroethoxysilane

X

White oil
 White Phosphorous

X

Xylene

Wide range system integration is available with Teikoku Diaphragm Pumps upon request. Such equipments as relief valves, pulsation damper, flowmeter, pressure transmitter, or auxiliary pipes / devices including electric facility and pneumatic system are often integrated into one package on a common skid. Eg., both stroke-length and s.p.m. can be controlled in preset sequence in response to signals of flow-rate, pressure, pH value, or the temperature. The controller can be retrofitted to any existing control-panel or be customized upon request. Please be informed that our production capacity of such C-panels is not limited to the one for our own diaphragm pumps. Touch-panel can make your control or alarm setting even easier. In a nutshell, we are not only a pump manufacturer but also your partner for the best system integration and solution.

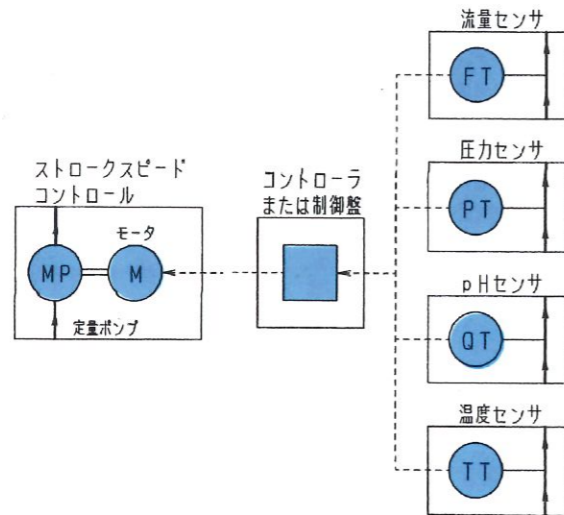

Sample Touch-Panel



Typical Application

- Chemical injection in water or sewage treatment.
- Liquefied gas injection into the extruder.
- Additive injection into the fuel, or odorizer injection into the object.
- Production line of coating, detergent, process food, or pharmaceuticals
- Back-flush-liquid injection into our own slurry-seal canned motor pumps.

Please contact our sales office with the specifications given below. We will quote the best metering pump suitable for your specifications. Provide the following information together with accessory list.

※ Standard/code to apply	
※ Quantity required	
Liquid name	
※ Temp/Melting point (°C)	/
※ SG / viscosity (mPa·s)	-/ /
※ Vapor pressure (kPaA)	
Name of solid/ Concentration	-/ (wt%) /
※ Size of solid / SG (μm) /-	/
※ Discharge flow (Max) (L/h)	
Discharge flow (Min) (L/h)	
※ Discharge press. (MPaG)	
※ Suction Press. (MPaG)	
※ Material of construction	SUS304 SUS316 Others ()
Material not allowed	

Fill in all ※columns.

Accessories

Name	Q'ty.	Specifications
Inverter		Preferred brand ()
Electric Noise Protection Device		Noise filter AC/DC Reactor
Pulsation damper		Bladder Diaphragm Belows Air chamber
Safety Valve / Relief Valve		Set press. () MPaG
Press. Retaining valve		Set press. 0.2MPaG 0.3MPaG
Calibration pot		Measuring time () sec.

TEIKOKU Group Global Network

TEIKOKU Electric Mfg.Co., Ltd. (Japan)

Plant & Business Headquarters Post Code : 679-4395
60 Hirano, Shingu-Cho, Tatsuno-Shi, Hyogo-Ken, Japan
Phone : +81-791-75-0411 Fax : +81-791-75-4190

International Business Headquarters Post Code : 110-0015
6F Shitaya Bldg. 2-5, 5-chome, Higashi-Ueno, Taito-Ku, Tokyo, Japan
Phone : +81-3-3841-9311 Fax : +81-3-3841-7334
E-mail : ibd-tokyo@teikokudenki.co.jp

TEIKOKU USA INC & CHEMPUMP Div. (North & South America)

TEIKOKU USA INC. 5880 Bingle Road, Houston, Texas 77092
Phone : +1-713-983-9901 Fax : +1-713-983-9919
E-mail : info@teikoku-usa.com
Web : www.teikoku-usa.com

CHEMPUMP Div. 959 Mearns Road, Warminster, PA 18974
Phone : +1-215-343-6000 Fax : +1-267-486-1037
E-mail : chempump@chempump.com
Web : www.teikoku-usa.com

TEIKOKU Electric GmbH (Europe)
Nuernberger Strasse 24, D-40599
Duesseldorf Germany
Phone : +49-211-700-6778
Fax : +49-211-749-0011
E-mail : info@teikoku-electric.de
Web : www.teikokupump.de

DALIAN TEIKOKU CANNED MOTOR
PUMP CO., LTD. (China)
中国大連三潤堡工業科技園区
Sanjianpu Science & Technology
Industry Area, Dalian, China
Phone : +86-411-8626-9657
Fax : +86-411-8626-9292
Web : www.teikoku-china.com

TEIKOKU SOUTH ASIA PTE LTD.
No.15, Joo Koon Crescent,
Singapore 629015
Phone : +65-6861-4121
Fax : +65-6861-4521
E-mail : info@teikoku-sa.com.sg
Web : (see US website)

TEIKOKU KOREA CO., LTD.
3F, Woonam-bldg., 197-19
Nonhyun-dong, Gangnam-gu, Seoul,
135-010, Korea
Phone : +82-2-790-7012
Fax : +82-2-790-7014
E-mail : webmaster@teikokukorea.co.kr
Web : www.teikokukorea.co.kr

TAIWAN TEIKOKU PUMP CO., LTD.
9F-1, No.5, Jinzhou st., Zhongshan
District, Taipei City 104,
Taiwan, R.O.C.
Phone : +886-2-2567-9800
Fax : +886-2-2568-2670
E-mail : ttppo@ms32.hinet.net
Web : (see US website)

